

# HAZARDOUS MATERIALS UNIT

## HAZARDOUS MATERIALS RE-INSPECTION MANAGEMENT PLAN

INCORPERATING ASBESTOS MANAGEMENT PLAN

Prepared & Updated by



Anthony Bulley

Technical Manager – Hazardous Materials

Dated..... 25 / 1 / 2013 .....

Agreed by Hazardous Materials Manager

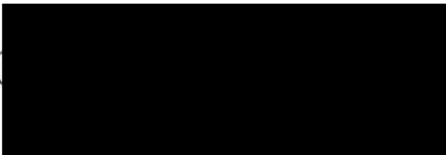

David Simpkins

Dated..... 25 / 1 / 2013 .....

## **Aims**

This management plan is agreed by the Tube Lines Hazardous Materials Unit (TLL HMU), its aim is to ensure that a cohesive plan for the re-inspection of all known asbestos containing materials (ACM's) and other hazardous materials across the Tube Lines network of assets including Jubilee, Northern and Piccadilly Lines (JNP);

The purpose of re-inspecting being to ensure all instances of ACM's remain in a safe and stable condition and that any deterioration is noted and any necessary remedial works are arranged to ensure that under no circumstance the condition becomes hazardous to the people who may use the various assets;

## **Current Information**

For all JNP Stations/Depots and Track Sections Survey information is listed on Summary Sheet (Examples - Appendix A);

Stations/Depots information is recorded against the Station/Depot Layout and Station Identification Codes (SID's) (Example - Appendix B);

Track information is recorded against the BRS Code & LCS Code;

Generic Rolling Stock Information is recorded on Pictograms for each type of Stock (Appendix C), all types of Hazardous Materials known to be found on this stock have been summarised on the attached Pictograms, it should be noted these are representative and should not be taken to indicate that all these items will be found on every car type or every car of that type;

Miscellaneous (e.g. Track Side Buildings or Disused Stations) are either recorded against a summary sheet (Appendix A) or a Visual Management Survey (Appendix D);

The information notes the structure of all areas and any Hazardous Materials known within;

Information on Summary Sheet contains a Materials Assessment & Priority Assessment (as per MDHS100), the Risk Assessment, the suggested management option, the last re-inspection/ survey date, ACA Rating and any remedial actions carried out to date against each Hazardous Material;

Information on Visual Management Survey contains a Materials Assessment;

However Various areas have not been surveyed; Information on these areas will be added during programmed re-inspections; Until then anyone working within these areas should contact the Tube Lines Hazardous Materials Unit by submitting a TLF-187 Risk Assessment form as per the Tube Lines Hazardous Materials procedure P334 prior to disturbing any materials or equipment that makes up the permanent structure;

### *General*

Though the majority of Hazardous Materials are now known, it should be noted that historically asbestos has been used in unusual applications throughout the LU (Tube Lines) network, therefore if any suspect materials are discovered then this should be reported back to the TLL HMU, out of normal office hours this should be via Tube Lines Control Centre;

### Recording of Findings

The purpose of the re-inspections is to record any deterioration of the ACM's on site sheets and where relevant to take an updated photo, this information will be recorded on the relevant document above, the site sheets and photos will be filed for future reference;

The re-inspections will also record any missing information relating to ACM's, e.g. quantity or exact

locations within the known area/room; and will record any changes of use within the said location;

### **Training**

All re-inspections will be carried out by member of the Tube Lines Hazardous Materials Unit who has passed the BOHS P402 Asbestos Surveying Course or who has been deemed competent by the Tube Lines Hazardous Materials Unit Manager;

Re-inspections carried out by 3<sup>rd</sup> Parties will be done by an approved Tube Lines Framework Asbestos Consultant;

All Tube Lines Staff or Operatives will have received Asbestos Awareness Training as part of their LU Safety Induction / Entry Permit training, which is renewed periodically;

### **Risk Assessments**

Due to the varying nature of differing assets controlled by Tube Lines Ltd, there are differing sets of training and requirements to access areas to re-inspect; Therefore when carrying out re-inspections the surveyor should ensure that they have the relevant training and the required access arrangements are in place;

All Electrical Equipment should be considered live and therefore cannot be re-inspected intrusively, unless isolations have been arranged;

Access to Inverts during re-inspections can only proceed if a Confined Space Rescue Team is in place and the relevant training is held by the Surveyor;

Track Sections can only be re-inspected during Engineering Hours or during any Possessions;

### **Priority Actions**

Due to the large quantities of assets and the limited resources available to re-inspect, it is necessary to prioritise areas over a 12-36month period;

Therefore below is a list of Tube Lines Assets and the period that they require re-inspecting due to the types of Hazardous Materials known within each one:

*Stations (excluding Platform Inverts & Platform Grounds):*

The following stations:

- due to the age of construction are considered to be asbestos free and therefore there is **no requirements to re-inspect:**
  - Jubilee Line:
    - Bermondsey, Canada Water, Canary Wharf, Canning Town, North Greenwich, Southwark, Stratford, West Ham;
- have no known asbestos containing materials therefore there are **no requirements to re-inspect:**
  - Jubilee Line:
    - Westminster;
  - Piccadilly Line:
    - Hounslow East (Station Buildings);

- only contain Electrical Equipment\* that are known to contain ACM's within, due to the ACM's being enclosed within, these are considered Low Priority and can be **re-inspected within a 36month period**:
  - Jubilee Line:
    - Dollis Hill, Kingsbury, Neasden, Stanmore, Queensbury;
  - Northern Line:
    - Brent Cross, Woodside Park;

*\* Electrical Switch Boxes are routinely managed by Tube Lines Signals and they have been instructed to notify Tube Lines HMU if any boxes are found with any asbestos that is in a damaged or deteriorated state;*
- have isolated ACM's where access is restricted therefore can only be **re-inspected when circumstances / opportunities allow**:
  - Jubilee Line:
    - London Bridge, Neasden;
  - Northern Line:
    - Burnt Oak;
- can be classed as **LOW** priority due to either the number and type of ACM's they contain and therefore can be restricted to **re-inspections every 24-36 months**:
  - Jubilee Line:
    - Canons Park, St John's Wood, Wembley Park;
  - Northern Line:
    - Archway, Balham, Belsize Park, Chalk Farm, Clapham Common, Clapham North, East Finchley, Finchley Central, Golders Green, Hampstead, Hendon Central, Kentish Town, Mill Hill East, Morden, Mornington Crescent, Oval, South Wimbledon, Tooting Bec, Tooting Broadway, Totteridge & Whetstone, Tufnell Park, West Finchley;
  - Piccadilly Line:
    - Alperton, Arsenal, Cockfosters, Heathrow T4, Manor House, North Ealing, Sudbury Town, Turnpike Lane;
- can be classed as **MEDIUM** priority due to either the number and type of ACM's they contain and therefore can be restricted to **re-inspections every 12-24 months**:
  - Jubilee Lines:
    - Finchley Road, Kilburn, Swiss Cottage, Waterloo, Willesden Green;
  - Northern Line:
    - Angel, Borough, Camden Town, Colindale, Colliers Wood, Clapham South, Edgware, Euston, Goodge Street, High Barnet, Highgate, Kennington, Old Street, Stockwell, Tottenham Court Road;
  - Piccadilly Line:
    - Acton Town, Amos Grove, Boston Manor, Bounds Green, Caledonian Road, Covent Garden, Ealing Common, Finsbury Park, Green Park, Hatton Cross, Heathrow T123, Holloway Road, Hounslow Central, Hounslow West, Hyde Park Corner, Knightsbridge, Leicester Square, Northfields, Oakwood, Osterley, Park Royal, Russell Square, South Ealing, Southgate, South Harrow, Sudbury Hill, Wood Green;
- can be classed as **HIGH** priority due to either the number and type of ACM's they contain and therefore can be restricted to **re-inspections every 12 months**:
  - None

- contain other Hazardous Materials that are to be **re-inspected periodically**:
  - Canary Wharf (Ammonia); Balham, Camden Town, Colliers Wood, Highgate, Kennington, Oval, Tooting Bec, Tooting Broadway, (All Polychlorinated Biphenyls);

*Platform Inverts:*

Due to the Low Risk Types of ACM's generally found plus the access restrictions for Platform Inverts, these areas will be re-inspected when the opportunities allow but not exceeding a period of **48 months period**;

Track Sections, Trackside building (where only access is by Track) and Platform Grounds:

Will be re-inspected by Tube Lines Framework Consultants over a **36month period**, as per Appendix E;

*Main Depots:*

Cockfosters & Northfields Depot will be re-inspected as per the Management Plan for each Depot;

Stratford Market Depot is deemed to be asbestos free due to the age of construction;

Northern Line Depots are managed by Alstrom and therefore fall out of Tube Lines demise;

For other Depots please see Other Assets;

*Rolling Stock:*

All known Hazardous Materials will be checked for damage by the maintenance staff and reported to the Duty Depot Manager (DDM), if a safe system of work has been agreed previously with the TLL HMU on how to replace the damaged item then the maintenance staff may proceed with this work;

If no safe system of work exists then the DDM should contact the TLL HMU via the Depot Manager to arrange any necessary remedial works;

Furthermore the TLL HMU will arrange to re-inspect a representative sample of the Rolling Stock every 24 months for signs of deterioration;

*Other Assets:*

*All other Tube Lines Trackside Buildings and other assets will be re-inspected as and when opportunities allow;*

***NB For all assets in-between re-inspections it is the responsibility of anyone working in/on the assets to report to the Tube Lines Control Centre any damage to any asbestos containing materials or other hazardous materials, who will then inform the TLL Hazardous Materials Unit;***

**NB Monitoring of the following asbestos containing materials have been noted has High priority, and notwithstanding the above, these items should be re-inspected every 12months;**

<b>Stations</b>	<b>SID Codes</b>	<b>Description</b>	<b>Asbestos Type</b>	<b>Status</b>
<b><u>Piccadilly Line</u></b>				
Acton Town	Platforms 1-4	Glazing Rope on Platform Glazing	Chrysotile	
Alpertton	1/151 - UMC	Investigate escalator circuit breaker	Asbestos	Museum
Arnos Grove	Platforms 1-4	Glazing Rope on Platform Glazing	Chrysotile	Spot Replaced?
Brompton Road	Ceiling to Accommodation	Ceiling Tiles	Amosite	Not LU Property
Brompton Road V/S	Cross passage	Redundant cabling in bad condition (40m)	Chrysotile	Not LU Property
Green Park	4/161 - LMC lobby area	Tunnel ring caulking	Amosite / Chrysotile	
	4/731 - CER	Ceiling panels 1m sqd	Amosite	
	4/161 - LMC	5 redundant asbestos cables cut	Chrysotile	
Hatton Cross	2/772 - Pump room	3 no. cable sleeves damaged	Chrysotile	
Hounslow Central	Platform canopy	Glazing bars - asbestos rope seal exposed	Chrysotile	
Hounslow West	Platforms	Upstand to platform ceilings	Amosite	Track & Station Closure Required

### Northern Line

Camden Town	Booking Hall & disused toilet on spiral stairs	Debris above false ceiling & ceiling in wc	Amosite	Station Closure Required
Tottenham Court Road	<del>6/771 - Flood gate chamber</del>	<del>Tunnel ring caulking requiring treatment</del>	<del>Amosite</del>	<del>Caulking removed Room No Longer Exists</del>
	4/901 - Disused	Tunnel ring caulking requiring treatment	Amosite	Encapsulated
	4/773 - Flood gate chamber	Tunnel ring caulking requiring treatment	Amosite	Encapsulated
	4/102 - LMC	1 no. 30mm cut asbestos cable requiring encapsulation	Chrysotile	

### Jubilee Line

Charing Cross	Cross Over	<del>Cellactite Sheeting</del>	Chrysotile	Removed
Willesden Green	2/413 - Store	Asbestos flashing boards high level	Amosite	

### Misc

Aldwych Disused	Disused Tunnel	Sprayed Debris to Tunnel Walls	Crocidolite	Encapsulated
Cockfosters Depot	Boiler house	Deep clean' of boiler room to remove an unknown quantity of amosite debris.	Amosite	
Highgate Depot	Shed	Cementitious Sheeting & Down Pipes	Chrysotile	Future of Depot to decided
Track Sections	Northern & Jubilee	See Appendix E	Amosite Chrysotile	

### **Management of this plan**

The plan is an agreed method of managing re-inspections of asbestos containing materials and other hazardous materials across the Tube Lines Ltd Network (Jubilee, Northern & Piccadilly Lines);

Please note that the following documents take precedence over this management plan:

Control of Asbestos Regulations 2012  
London Underground Asbestos Standard S301  
Tube Lines Asbestos Management Procedure P334 Rev4

The owner of this plan is the Tube Lines Hazardous Materials Unit;

The Tube Lines Hazardous Materials Unit is comprised of personnel holding the P402 & P405 BOHS qualification in asbestos management and surveying and they will ensure the quality of all information recorded within this plan and its appendixes.

### **Review**

This plan will be reviewed **12 months** after its implementation and then as and when required by changes to legislation or changes to Tube Lines procedures or operational requirements.





# HAZARDOUS MATERIALS UNIT

## ASBESTOS MANAGEMENT & RE-INSPECTION PLAN

### APPENDIX A

**QUEENSBURY STATION  
SUMMARY OF KNOWN/SUSPECTED HAZARDOUS MATERIALS**



The purpose of this summary report is to detail the presence of any known (K) Asbestos Containing Materials (ACMs) within the Asset. Any areas inaccessible during the Type 2 survey are presumed (P) or strongly presumed (SP) to contain ACMs until known otherwise. All inaccessible areas will need to be surveyed prior to work being undertaken in these areas. This sheet was last updated **October 2007** and is provided for information only. Prior to any intrusive works commencing a TLF-187 must be submitted to the HMU.

All contractors working on Tube Lines property must remain vigilant during their works and if any suspect material is encountered which is likely to be disturbed, the Hazardous Materials Unit (HMU) must be contacted before continuing.

For further guidance contact the HMU - Email [asbestos@tube-lines.com](mailto:asbestos@tube-lines.com)

View/Hide Materials/Priority Assessments

**B685 QUEENSBURY**  
Jubilee Line

**Colour Key to Summary Sheet**

- Asbestos/Lead paint was present in room/location but was removed.
  - Asbestos is Presumed (P) Strongly Presumed (SP) or Known (K) to be present in location
  - Lead paint is present in room/location
- Historically asbestos has been used in unusual applications throughout LUL (Tube Lines) network. Therefore, all contractors must remain vigilant during the course of their work and if any suspect materials are encountered, the Asbestos Management Unit must be contacted before continuing.

ID. No.	Description	Comments	Floors	Below false floors	Walls	Ceilings/False ceiling	Above False ceilings	Material Assessment				Priority Assessment				Risk Assessment	Date Identified	ACA Rating	Management Option	Last Re Inspection	Mitigation	Date
								Product Type	Damage	Surface	Asbestos	Score	Normal Activity	Disturbance	Exposure							
NOTE All Heaters are foam insulated on this station																						
1/001	Booking Hall	None visible	Tiled		Concrete	Concrete, Supalux facade above ticket office																
1/011	Ticket Office	None visible	Tiled		Concrete	Pipe lagging - Fibreglass Concrete/Wooden flooring	Supalux	Concrete														
1/021	Pom	None visible	Tiled		Concrete	Concrete																
1/031	Mess Room	None visible	Tiled		Concrete	Concrete & Supalux																
1/036	Toilet	None visible	Tiled		Concrete	Concrete																
1/081	Lobby	None visible	Tiled		Concrete	Acoustic panel by sink - Non asbestos																
1/083	Lobby	None visible	Concrete		Concrete	Concrete																
1/084	Lobby	None visible	Concrete		Concrete	Concrete																
1/201	Passage	None visible	Concrete		Concrete	Concrete																
1/202	Passage	None visible	Concrete		Concrete	Pipe work - Fibreglass	Concrete															
1/281	Office	Asbestos-SP Non visible	Tiled		Concrete	Supalux	Concrete															
1/406	Store	None visible	Tiled		Concrete	Asbestos SP 3x chrysotile chimney flues on roof																
1/426	Toilet	None visible	Tiled		Concrete	Concrete																
1/427	Toilet	None visible	Tiled		Concrete	Plasterboard																
1/428	Toilet	None visible	Tiled		Concrete	Plasterboard																
1/451	Tenancy	None visible	Tiled		Concrete	Plasterboard																
1/452	Tenancy	None visible	Tiled		Concrete	Plasterboard																
1/661	Switch Room	Asbestos SP	Concrete		Concrete	Concrete																
1/662	Switch Room	Asbestos SP	Concrete		Concrete	Asbestos SP 16x Iron clad Isolators (8x Wall 3, 1x Wall 1)																
1/663	Switch room	Asbestos SP	Concrete		Concrete	Asbestos SP 6x Iron Clad Isolators																
1/745	Store	None visible	Concrete		Concrete	Asbestos SP 5x Grey 1x Blue Iron clad Isolators																
2/406	Store	None visible	Concrete		Concrete	Concrete & Supalux tiles																
2/661	Switch Room Platform 1	Asbestos SP	Concrete		Concrete	Asbestos SP 6x Isolators (5x Wall 3, 1x Wall 1)																
A/261	Platform 1	Lead Paint Removed	Concrete		Concrete	Fire/aid stretcher Green oil based 2sqm Fence White oil based 100sqm sand bin Red oil based 2sqm																
A/262	Platform 2	Lead Paint Removed	Concrete		Concrete	Canopy - Concrete Fence White oil based 10sqm																
A/331	Mess Room	None visible	Tiled		Concrete	Concrete																
A/436	Waiting Room	None visible	Concrete		Brick	Concrete																
A/437	Waiting Room	None visible	Concrete		Brick	Concrete																
A/481	Store	None visible	Concrete		Concrete	Concrete																
A/482	Phone Booth	None visible	Concrete		Brick	Concrete																
A/483	Phone Booth	None visible	Concrete		Brick	Concrete																
A/601	Stairs	None visible	Brick & Concrete		Brick & Concrete	Concrete																
A/602	Stairs	None visible	Brick & Concrete		Brick & Concrete	Brick & Concrete																
A/711	Ser	None visible	Concrete		Concrete	Concrete																
0/663	CER	Asbestos SP	Concrete		Concrete	Asbestos SP 2x Isolators Wall 1 (Car Park)																
Yard Areas	Asbestos-K Non visible	None visible	Concrete		Concrete	Asbestos K Red door with broken cement panel in Bin store located un Yard areas																

**QUEENSBURY STATION  
SUMMARY OF KNOWN/SUSPECTED HAZARDOUS MATERIALS**



The purpose of this summary report is to detail the presence of any known (K) Asbestos Containing Materials (ACMs) within the Asset. Any areas inaccessible during the Type 2 survey are presumed (P) or strongly presumed (SP) to contain ACMs until known otherwise. All inaccessible areas will need to be surveyed prior to work being undertaken in these areas. This sheet was last updated October 2007 and is provided for information only. Prior to any intrusive works commencing a TLF-187 must be submitted to the HMU.

All contractors working on Tube Lines property must remain vigilant during their works and if any suspect material is encountered which is likely to be disturbed, the Hazardous Materials Unit (HMU) must be contacted before continuing.

For further guidance contact the HMU - Email [asbestos@tube-lines.com](mailto:asbestos@tube-lines.com)

[View/Hide Materials/Priority Assessments](#)

**B085 QUEENSBURY**  
Jubilee Line

**Colour Key to Summary Sheet**

 Asbestos/Lead paint was present in room/location but was removed.

Historically asbestos has been used in unusual application throughout LUL (Tube Lines) network. Therefore, all contractors must remain vigilant during the course of their work and if any suspect materials are encountered, the Asbestos Management Unit must be contacted before continuing.

 Asbestos is Presumed (P) Strongly Presumed (SP) or Known (K) to be present in location

 Lead paint is present in room/location

ID. No.	Description	Comments	Floors	Below false Floors	Walls	Ceilings/False ceiling	Above False ceilings	Material Assessment					Priority Assessment					Risk Assessment	Date Identified	ACA Rating	Management Option	Last Re Inspection	Mitigation	Date
								Product Type	Damage	Surface	Asbestos	Score	Normal Activity	Disturbance	Exposure	Maintenance Activity	Score							

**Risk Assessment Priority Scores**

Risk	Value	Comments
High	18 or Higher	Manage ACM and carry out planned remedial action to reduce the risk score, typically within 6 months or less, to below risk score 18 in accordance with the asbestos management policy
Medium	12 to 17 or higher	Manage as high risk but remedial action can be deferred until maintenance regimes change or demolition or major refurbishment is planned.
Low	11 or less	Manage and consider removal if the item fails within a demolition, major refurbishment or maintenance regimes change and works are likely to disturb the material.

**Survey Reports**

LOCATION	EXAMINATION	DATE	REF No.	COMPANY	RACU	Summary	Note bk
TYPE 2 - Asbestos Survey	Type 2 - Asbestos Survey	29/01/2002	R1043	4-RAIL Services	✓	✓	
Lead Paint Survey	Lead Paint	15/05/2007	R7501C0090	A.C.E	✓	✓	
Slip Resistance Assessment - Platform Areas	Slip Resistance Assessments	06/10/2005	R105476	4-RAIL Services	✓		
Heat gun assessments	Heat Gun Assessments	23/07/2007	R110551	4-RAIL Services	✓		



# HAZARDOUS MATERIALS UNIT

## ASBESTOS MANAGEMENT & RE-INSPECTION PLAN

### APPENDIX B



# Queensbury

## Axonometric

# STATION LAYOUT

Not for construction purposes



Total of 06 Drawings B085-01 to 06	Drawing number: <b>B085-02s</b>
Issue: 13 (2004/05)	Revision:
Survey Date: 18:08:04	Date:
Drawn by: RCD	Drawn by:
Information current at date shown. For latest information contact Building Control 020 7088 4362/4356/4361	

If any alterations or additions are needed to these layouts please contact Building Control, Tube Lines Limited.

Axonometric Drawing Not Available

MStin->PDF A3

Plotted by : BALDWIDA EIS

30/11/04  
© Tube Lines Limited. Produced by Building Control, Tube Lines Limited. Enquiries should be directed to 020 7088 4362/4356/4361



# Queensbury Street Plan

# STATION LAYOUT

Not for construction purposes



**Tube Lines**

15 Westferry Circus  
Canary Wharf  
London E14 4HD

Total of 06 Drawings  
B085-01 to

Drawing number:  
**B085-03s**

Issue: 13 (2004/05)

Revision:

Survey Date: 18:08:04

Date:

Drawn by:

RCD Drawn by:

Information current at date shown. For  
latest information contact Building Control  
020 7088 4362/4356/4361

If any alterations or additions are needed to these layouts please contact Building Control, Tube Lines Limited.

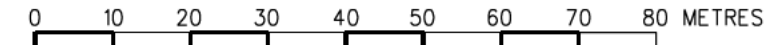
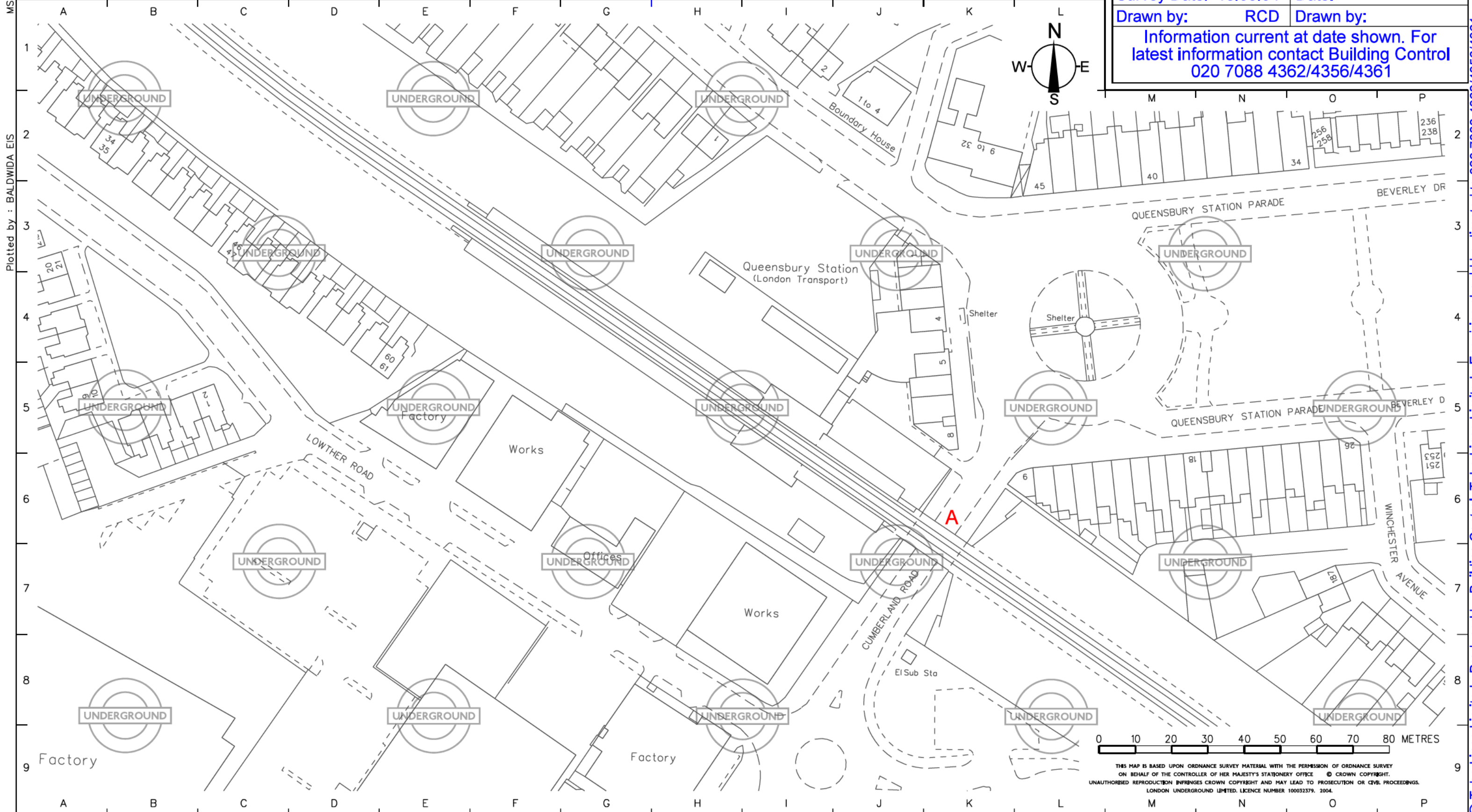

THIS MAP IS BASED UPON ORDNANCE SURVEY MATERIAL WITH THE PERMISSION OF ORDNANCE SURVEY  
ON BEHALF OF THE CONTROLLER OF HER MAJESTY'S STATIONERY OFFICE © CROWN COPYRIGHT.  
UNAUTHORISED REPRODUCTION INFRINGES CROWN COPYRIGHT AND MAY LEAD TO PROSECUTION OR CIVIL PROCEEDINGS.  
LONDON UNDERGROUND LIMITED. LICENCE NUMBER 100033379. 2004.

MStin->PDF A3

Plotted by : BALDWIDA EIS

30/11/04

© Tube Lines Limited. Produced by Building Control, Tube Lines Limited. Enquiries should be directed to 020 7088 4362/4356/4361

# Queensbury

## Ticket Hall

# STATION LAYOUT

Not for construction purposes



Total of 06 Drawings B085-01 to 06	Drawing number: <b>B085-04s</b>
Issue: 13 (2004/05)	Revision:
Survey Date: 18:08:04	Date:
Drawn by: RCD	Drawn by:
Information current at date shown. For latest information contact Building Control 020 7088 4362/4356/4361	

If any alterations or additions are needed to these layouts please contact Building Control, Tube Lines Limited.

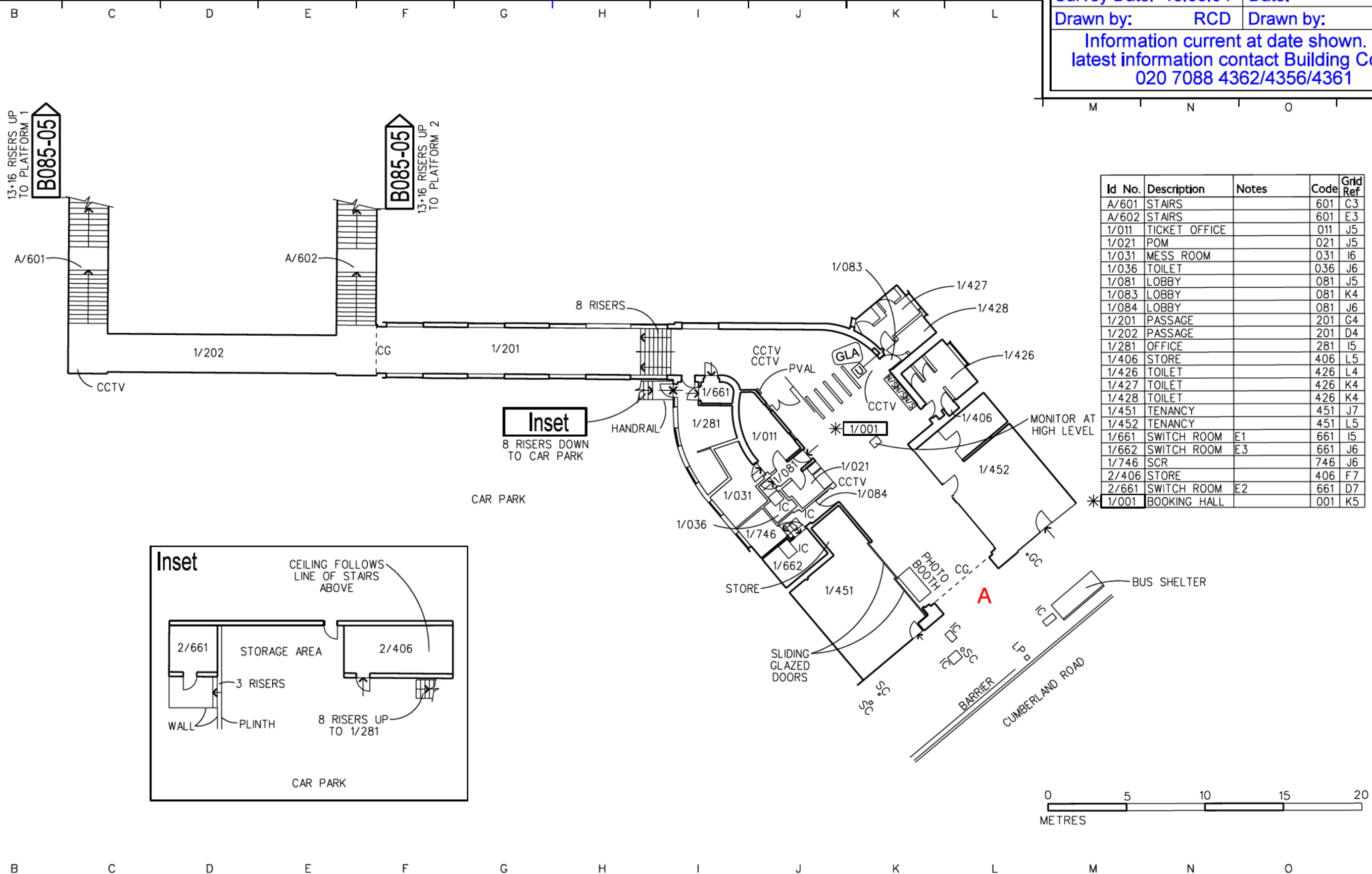

Id No.	Description	Notes	Code	Grid Ref
A/601	STAIRS		601	C3
A/602	STAIRS		601	E3
1/011	TICKET OFFICE		011	J5
1/021	POM		021	J5
1/031	MESS ROOM		031	I6
1/036	TOILET		036	J6
1/081	LOBBY		081	J5
1/083	LOBBY		081	K4
1/084	LOBBY		081	J6
1/201	PASSAGE		201	G4
1/202	PASSAGE		201	D4
1/281	OFFICE		281	I5
1/406	STORE		406	L5
1/426	TOILET		426	L4
1/427	TOILET		426	K4
1/428	TOILET		426	K4
1/451	TENANCY		451	J7
1/452	TENANCY		451	L5
1/661	SWITCH ROOM	E1	661	I5
1/662	SWITCH ROOM	E3	661	J6
1/746	SCR		746	J6
2/406	STORE		406	F7
2/661	SWITCH ROOM	E2	661	D7
1/001	BOOKING HALL		001	K5

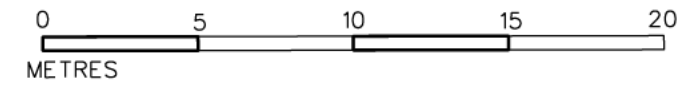
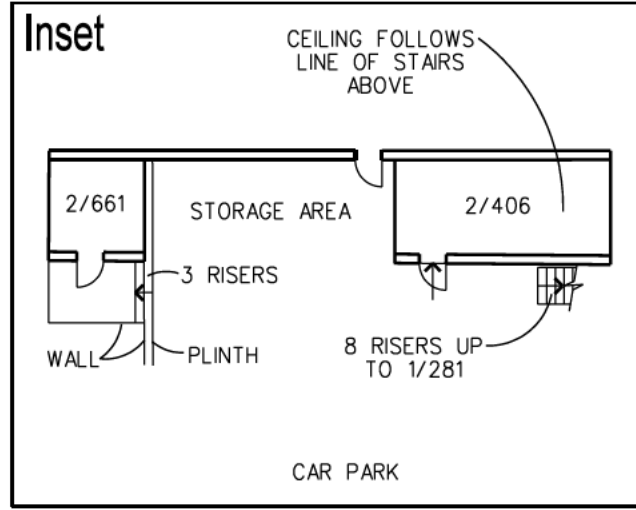

Plotted by : BALDWIDA EIS

Tube Lines Limited. Produced by Building Control, Tube Lines Limited. Enquiries should be directed to 020 7088 4362/4356/4361



# Queensbury

## Platforms 1 & 2 (South End)

# STATION LAYOUT

Not for construction purposes



Total of 06 Drawings B085-01 to 06	Drawing number: <b>B085-05s</b>
Issue: 13 (2004/05)	Revision:
Survey Date: 18:08:04	Date:
Drawn by: RCD	Drawn by:
Information current at date shown. For latest information contact Building Control 020 7088 4362/4356/4361	

If any alterations or additions are needed to these layouts please contact Building Control, Tube Lines Limited.

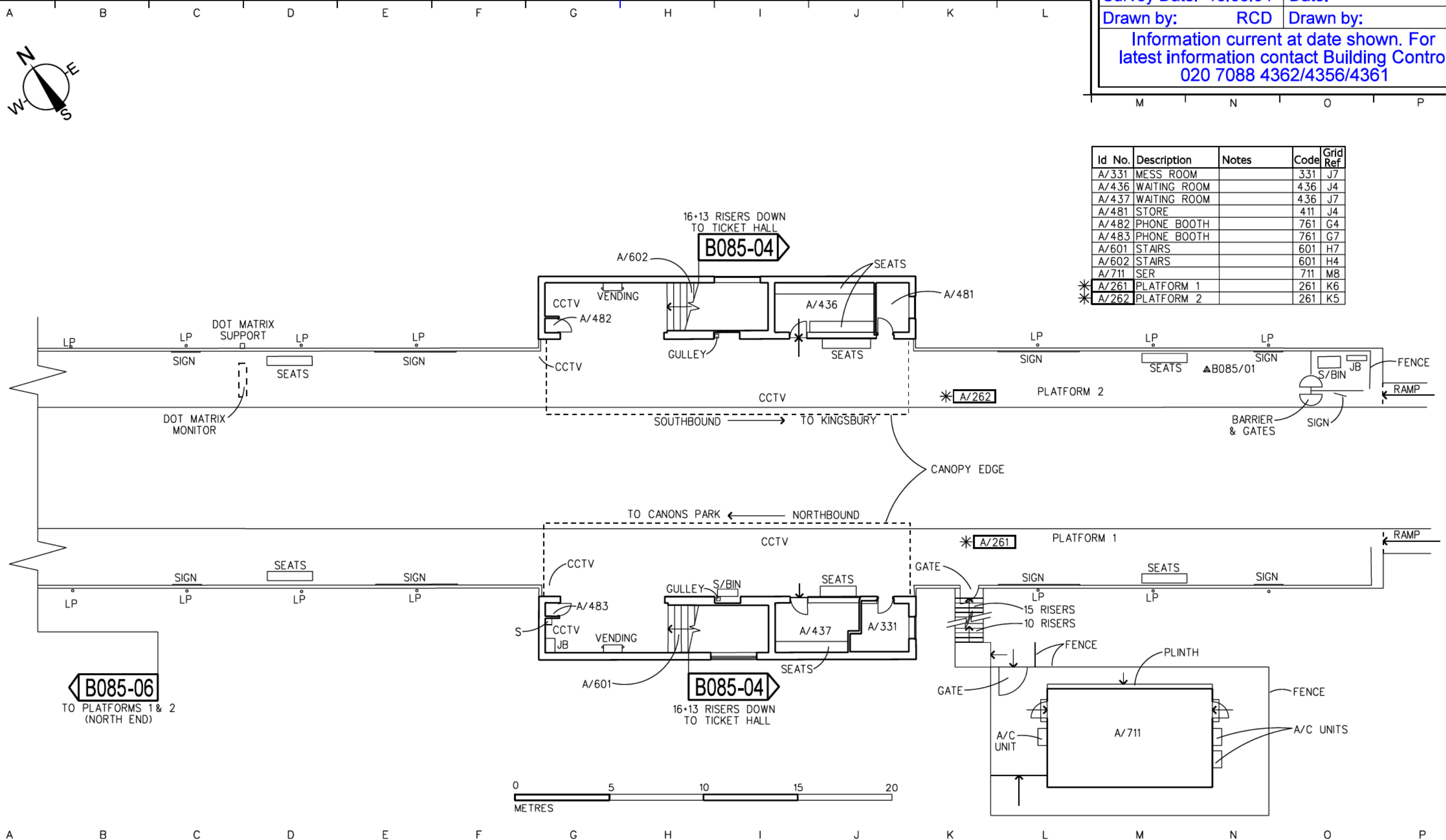

Id No.	Description	Notes	Code	Grid Ref
A/331	MESS ROOM		331	J7
A/436	WAITING ROOM		436	J4
A/437	WAITING ROOM		436	J7
A/481	STORE		411	J4
A/482	PHONE BOOTH		761	G4
A/483	PHONE BOOTH		761	G7
A/601	STAIRS		601	H7
A/602	STAIRS		601	H4
A/711	SER		711	M8
*A/261	PLATFORM 1		261	K6
*A/262	PLATFORM 2		261	K5

Plotted by : BALDWIDA EIS  
30/11/04  
Enquiries should be directed to 020 7088 4362/4356/4361  
Tube Lines Limited. Produced by Building Control, Tube Lines Limited.

# Queensbury

## Platforms 1 & 2 (North End)

# STATION LAYOUT

Not for construction purposes



**Tube Lines**

15 Westferry Circus  
Canary Wharf  
London E14 4HD

Total of 06 Drawings  
B085-01 to 06

Drawing number:  
**B085-06s**

Issue: 13 (2004/05)

Revision:

Survey Date: 18:08:04

Date:

Drawn by: RCD

Drawn by:

Information current at date shown. For latest information contact Building Control 020 7088 4362/4356/4361

If any alterations or additions are needed to these layouts please contact Building Control, Tube Lines Limited.



Id No.	Description	Notes	Code	Grid Ref
*A/261	PLATFORM 1		261	G7
*A/262	PLATFORM 2		261	G6

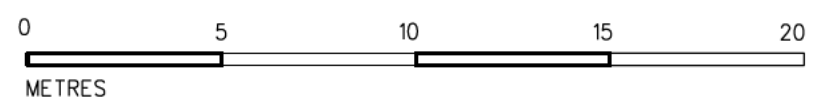
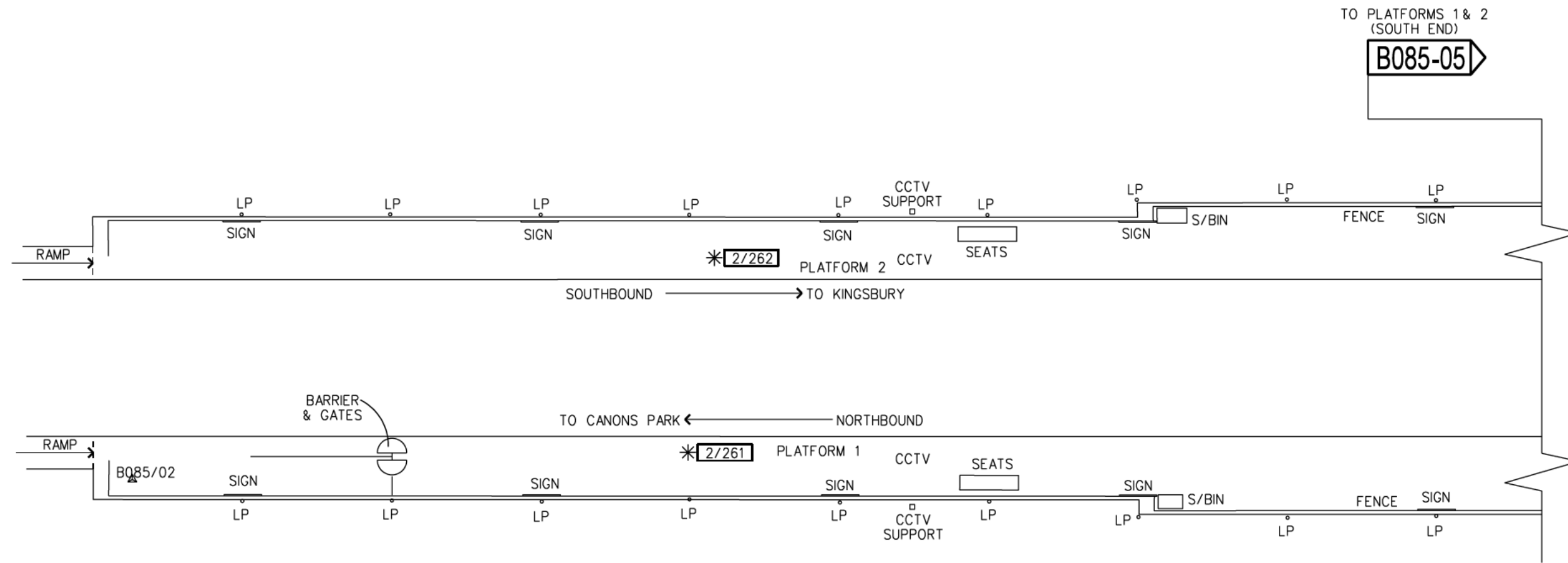

Plotted by : BALDWIDA EIS  
30/11/04  
Enquiries should be directed to 020 7088 4362/4356/4361  
Tube Lines Limited. Produced by Building Control, Tube Lines Limited.



# HAZARDOUS MATERIALS UNIT

## ASBESTOS MANAGEMENT & RE-INSPECTION PLAN

### APPENDIX C



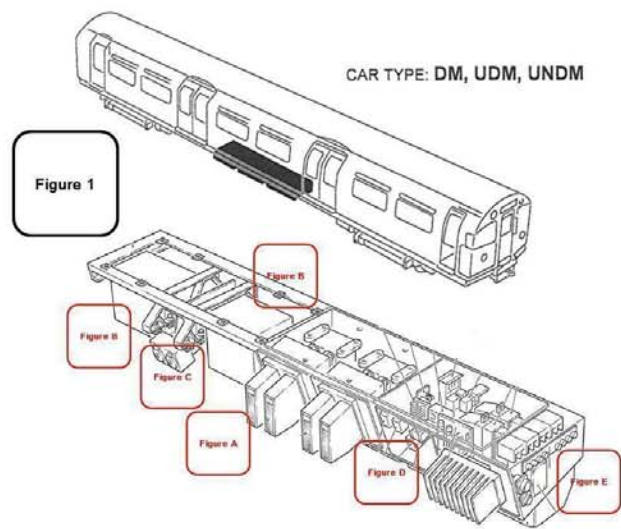

Figure A  
Cement panel boxing  
1.8m<sup>2</sup>  
To arc chute,  
Chrysotile



Arc chutes  
Chrysotile

Figure A



Figure B  
Cement panels / lining 0.25m<sup>2</sup>  
Within main negative fuse box  
Chrysotile

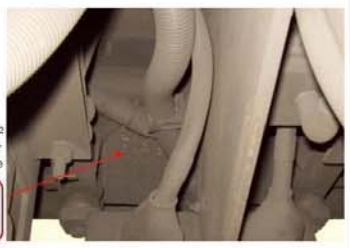

Figure C  
Durasteel 0.25m<sup>2</sup>  
Above jumper  
Amosite & Chrysotile



Figure D  
Arc chutes 2no.  
To contactor  
Chrysotile



Figure D  
Black panel 1no.  
To contactor  
Chrysotile

Figure D



Figure D  
Arc chutes 4no.  
Chrysotile

Figure E  
2no. <1m<sup>2</sup> Cement Panel  
To switch behind large arc chutes  
Chrysotile



Figure E

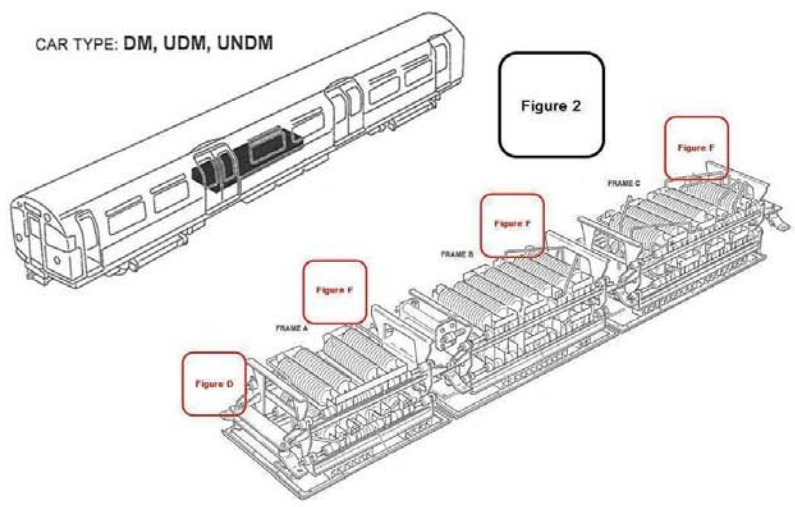

Figure F  
Durasteel 10m<sup>2</sup>  
To mid section above resistor grids A, B and C  
Amosite & Chrysotile



Figure G  
Washers  
To resistor grids frame  
Chrysotile



Figure H  
Not on  
Layout  
Durasteel 0.25m<sup>2</sup>  
Undercarriage,  
Above air exhaust system next to resistor grids  
Amosite & Chrysotile



Figure I  
Not on  
Layout  
Durasteel 0.25m<sup>2</sup>  
Undercarriage,  
Between wheels  
Amosite & Chrysotile

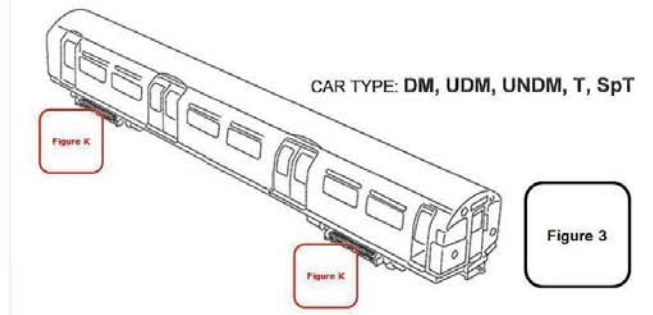

Figure K  
Durasteel 0.25m<sup>2</sup>  
Undercarriage  
Between wheels  
Amosite & Chrysotile

Car - Internal



Figure L  
Black panel 2no.  
Internals  
To knife switch box - wooden boxing  
Chrysotile

Figure L

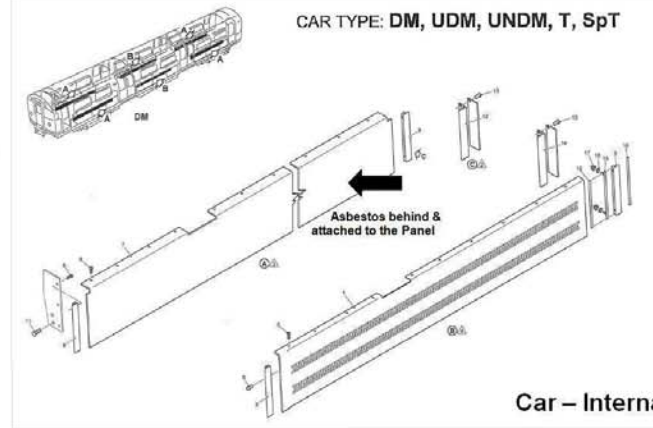
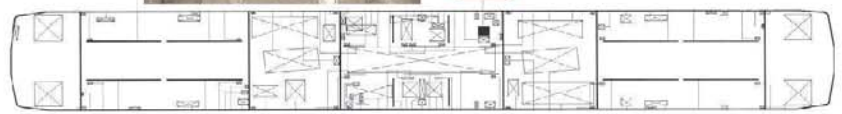

Figure I  
Not on  
Layout  
Durasteel 0.25m<sup>2</sup>  
Undercarriage,  
Between wheels  
Amosite & Chrysotile

Asbestos behind & attached to the Panel

Car - Internal

1973 Piccadilly Line Rolling Stock  
Location of Hazardous Materials Pictogram

Please read:

These Pictograms are representative and should not be taken to indicate that all these items will be found on every car type or every car of that type;

Neither should it be taken to represent all Hazardous Materials, as historically asbestos has been used in unusual applications throughout the LU (Tube Lines) network;

However we are confident that all known asbestos items are known and are listed, but if you do believe you encounter any suspect material please pass your concerns to the Duty Depot Manager who will contact the Tube Lines Hazardous Materials Unit for confirmation;

If any items on this Pictogram are found to be damaged, please report this to the Duty Depot Manager; Who will either:

- arrange for the damaged item to be replaced, if a safe system of works is in place;
- will inform the Tube Lines Hazardous Materials Unit, who will arrange for the necessary remedial works;

This document was produced by the Tube Lines Hazardous Materials Unit on the 15<sup>th</sup> December 2010;

Mercury

CAR TYPE: DM, UDM, UNDM, T, SpT  
TITLE: INTERLOCK

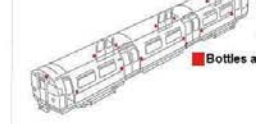

Bottles at Each Door

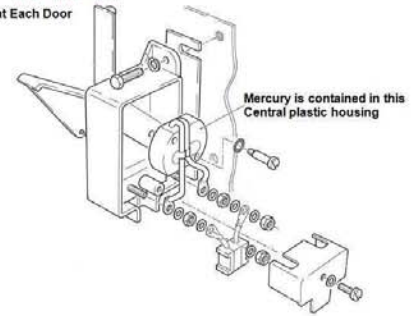

Mercury is contained in this Central plastic housing

Car - Internal



# HAZARDOUS MATERIALS UNIT

## ASBESTOS MANAGEMENT & RE-INSPECTION PLAN

### APPENDIX D



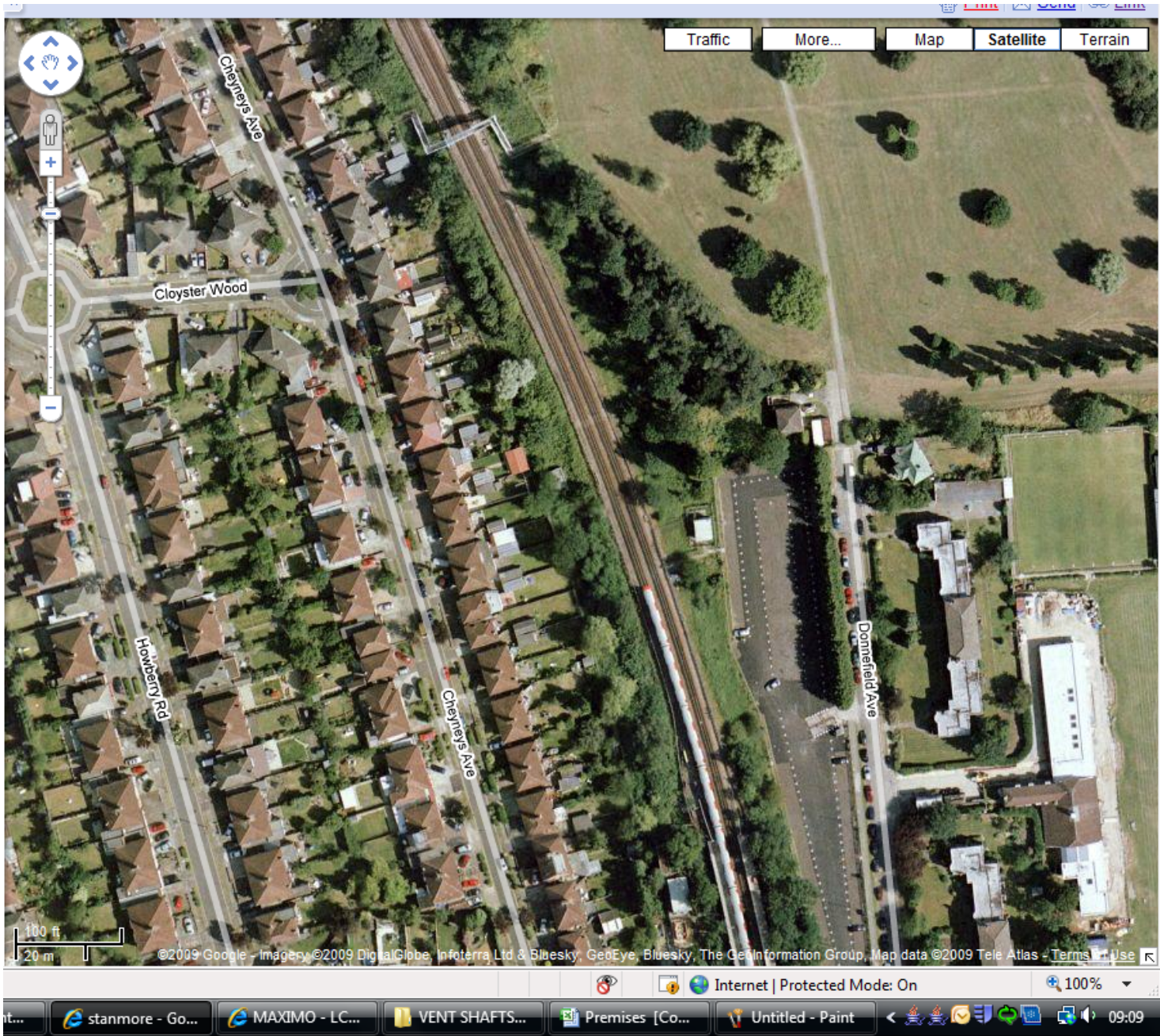

AREA: Canons Park – Stanmore	CLIENT: Tube Lines Limited	DATE OF SURVEY: 24/03/2009	SURVEYOR (S): APB/ PH
------------------------------	----------------------------	----------------------------	-----------------------

Sample No.	Area Surveyed		Material Description	Quantity (m <sup>2</sup> )	Product Type	Current Condition	Surface Treatment	Potential for Disturbance	Asbestos Type	Comments and Recommendations	Photo
	Location	Room/ Plant No									
	Relay Room	0/711								New Build	
			Insulation within Switch Box	1no					SP	1no 30amp	No Photo
	SER	0/712	Terracotta Tiles							Floor	
			Paxoline Boards						P	Throughout Room	No Photo
	Disused P-Way Building	1/371 (1 <sup>st</sup> Room)	Brick							Building	
			Crittall Windows						Lead Paint (P)		
			Wood							Ceiling	
			Tiles							Walls & Floor	
			Acoustic Panel						P	Under Sink	1
			DRU Heater						P		2
			W = Wall PW = Partition wall C= Ceiling F = Floor FC = False ceiling AFC = Above false ceiling CA = Cable		1.Composite 2.Medium density 3.High friable	0.Good condition 1.Slight damage 2.Moderate damage 3.Extensive damage	0.Composite 1.Encapsulated medium density 2.Unencapsulated medium density or treated highly friable 3.Untreated highly friable	1.Very Low 2.Low 3.Medium 4.High	P = presumed SP = strongly presumed 0.Non-asbestos 1.Chrysotile 2.Amphibole excluding Crocidolite 3. Crocidolite		

Sample No.	Area Surveyed		Material Description	Quantity (m <sup>2</sup> )	Product Type	Current Condition	Surface Treatment	Potential for Disturbance	Asbestos Type	Comments and Recommendations	Photo
	Location	Room/ Plant No									
			Cement Duct						P	To External	3
	Disused P-Way Building	1/371 (2nd Room)	Door Locked						P	No Access	
	CER	0/731								New Build	
	CER/ UPS	0/711	Prefabricated							Building	
			Paxoline Boards						P	Throughout Room	No Photo
			Plastic							Cables	
			Insulation within Switch Box	3no					SP	1no 30amp; 2no 60amp	No Photo
	SER	0/713								New Build	
			W = Wall PW = Partition wall C= Ceiling F = Floor FC = False ceiling AFC = Above false ceiling CA = Cable		1.Composite 2.Medium density 3.High friable	0.Good condition 1.Slight damage 2.Moderate damage 3.Extensive damage	0.Composite 1.Encapsulated medium density 2.Unencapsulated medium density or treated highly friable 3.Untreated highly friable	1.Very Low 2.Low 3.Medium 4.High	P = presumed SP = strongly presumed 0.Non-asbestos 1.Chrysotile 2.Amphibole excluding Crocidolite 3. Crocidolite		



Photo 1: Acoustic Panel

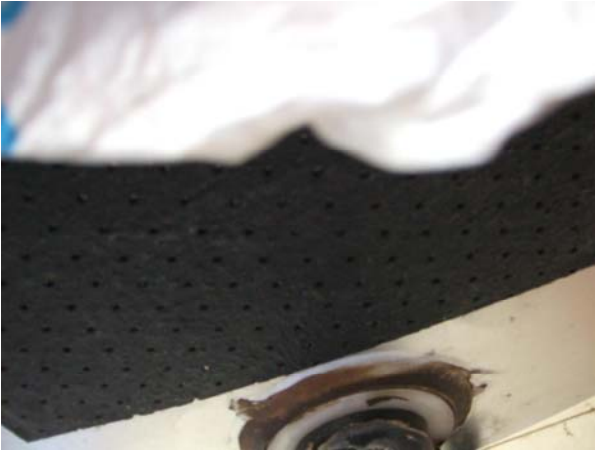

Photo 2: DRU Heater



Photo 2: Cement Duct



HMU Surveyor: Anthony Bulley

Signed: 

Date: 21/04/2009



# HAZARDOUS MATERIALS UNIT

## ASBESTOS MANAGEMENT & RE-INSPECTION PLAN

### APPENDIX E

## Priority Actions – Track Sections & Platform Grounds

Due to the large quantities of assets and the limited resources available to re-inspect, it is necessary to prioritise the areas that are re-inspection over a 12-36month period;

The following areas:

- due to the age of construction these areas are considered to be asbestos free and therefore there is **no requirements to re-inspect**:
  - Jubilee Line:
    - Platform Grounds & Track Sections – Both Directions in between
      - Stratford
      - West Ham
      - Canning Town
      - North Greenwich
      - Canary Wharf
      - Bermondsey
      - London Bridge
      - Southwark
      - Waterloo
      - Westminster
  - Northern Line:
    - None
  - Piccadilly Line:
    - Track Sections – Both Directions
      - Heathrow T5 Extension
    - Platform Grounds (All)
      - Heathrow T5
- have no known asbestos containing materials therefore there are **no requirements to re-inspect**:
  - Jubilee Line:
    - Track Sections – Both Directions
      - None
    - Platform Grounds (All)
      - Dollis Hill
      - West Hampstead
      - Swiss Cottage
      - St Johns Wood
      - Bond Street
      - Green Park
      - Charing Cross
  - Northern Line:
    - Track Sections – Both Directions
      - None
    - Platform Grounds (All)
      - Burnt Oak
      - Tottenham Court Road
      - Waterloo
  - Piccadilly Line:
    - Track Sections – Both Directions

- None
- Platform Grounds (All)
  - Manor House
  - Osterley
  - Hounslow East
  - Boston Manor
  - Hounslow Central
  - Hounslow West
  - Hatton Cross
  - Rayners Lane
  - South Harrow
  - Sudbury Hill
  - Sudbury Town
  - Alperton
  - Park Royal
  - North Ealing
- only contain Electrical Equipment\* that are known to contain ACM's within, due to the ACM's being enclosed within, these are considered Low Priority and can be **re-inspected within a 36month period:**
  - Jubilee Line:
    - Track Sections – Both Directions
      - Wembley Park Sidings
      - Neasden to Dollis Hill
      - Willesden Green to Kilburn
    - Platform Grounds (All)
      - Stanmore
      - Canons Park
      - Willesden Green
  - Northern Line:
    - Track Sections – Both Directions
      - Golders Green to Brent Cross
    - Platform Grounds (All)
      - West Finchley
      - Brent Cross
      - Edgware
      - Moorgate
      - Morden
  - Piccadilly Line:
    - Track Sections – Both Directions
      - Boston Manor to Osterley
      - Hatton Cross to Heathrow T4
      - Sudbury Town to Alperton
    - Platform Grounds (All)
      - Turnpike Lane
      - Kings Cross
      - Holborn
      - Leicester Square
      - Piccadilly Circus
      - Green Park

- Gloucester Road
- Earls Court
- South Ealing
- Northfields

*\* Electrical Switch Boxes are routinely managed by Tube Lines Signals and they have been instructed to notify Tube Lines HMU if any boxes are found with any asbestos that is in a damaged or deteriorated state;*

- can be classed as **LOW** priority due to either the number and type of ACM's they contain and therefore can be restricted to **re-inspections every 24-36 months**:
  - Jubilee Line:
    - Track Sections – Both Directions
      - Stanmore Sidings
      - Canons Park to Queensbury
      - Queensbury to Kingsbury
      - Charing Cross Sidings
    - Platform Grounds (All)
      - Wembley Park
      - Queensbury
      - Kingsbury
      - Neasden
      - Finchley Road
  - Northern Line:
    - Track Sections – Both Directions
      - High Barnet Sidings
      - Woodside Park to West Finchley
      - West Finchley to Finchley Central
      - Mill Hill East to Finchley Central
      - Finchley Central to East Finchley
      - Bank to London Bridge
      - London Bridge to Borough
      - Borough to Elephant and Castle
      - Euston to Warren Street
      - Warren Street to Goodge Street
      - Goodge Street to Tottenham Court Road
    - Platform Grounds (All)
      - Mill Hill East
      - Belsize Park
      - Hampstead
      - Hendon Central
      - Colindale
      - Old Street
      - Bank
      - London Bridge
      - Borough
      - Elephant and Castle
      - Kennington
      - Euston
      - Warren Street
      - Goodge Street
      - Embankment
      - Stockwell

- Clapham Common
  - Clapham South
  - Tooting Bec
  - Colliers Wood
  - South Wimbledon
- Piccadilly Line:
  - Track Sections – Both Directions
    - Leicester Square to Piccadilly Circus
    - Gloucester Road to Earls Court
    - South Ealing to Northfields
    - Hounslow Central to Hounslow West
  - Platform Grounds (All)
    - Oakwood
    - Southgate
    - Arnos Grove
    - Bounds Green
    - Wood Green
    - Covent Garden
    - South Kensington
- can be classed as **MEDIUM** priority due to either the number and type of ACM's they contain and therefore can be restricted to **re-inspections every 12-24 months**:
  - Jubilee Lines:
    - Track Sections – Both Directions
      - Stanmore to Canons Park
      - Kingsbury to Wembley Park
      - Wembley Park to Preston Road
      - Wembley Park to Neasden
      - Dollis Hill to Willesden Green
      - Kilburn to West Hampstead
      - West Hampstead to Finchley Road
    - Platform Grounds (All)
      - Kilburn
      - Baker Street
  - Northern Line:
    - Track Sections – Both Directions
      - High Barnet Buffer Roads
      - High Barnet to Totteridge & Whetstone
      - Totteridge & Whetstone to Woodside Park
      - Finchley Central to Mill Hill East
      - Archway to Tufnell Park
      - Tufnell Park to Kentish Town
      - Kentish Town to Camden Town
      - Camden Town to Chalk Farm
      - Chalk Farm to Belsize Park
      - Belsize Park to Hampstead
      - Brent Cross to Hendon Central
      - Hendon Central to Colindale
      - Colindale to Burnt Oak
      - Burnt Oak to Edgware
      - Edgware Sidings
      - Euston to Kings Cross
      - Kings Cross to Angel

- Angel to Old Street
  - Old Street to Moorgate
  - Moorgate to Bank
  - Elephant and Castle to Kennington
  - Kennington Loop
  - Camden Town to Mornington Crescent
  - Euston to Mornington Crescent
  - Tottenham Court Road to Leicester Square
  - Leicester Square to Charing Cross
  - Charing Cross to Embankment
  - Embankment to Waterloo
  - Kennington to Oval
  - Oval to Stockwell
  - Stockwell to Clapham North
  - Clapham North to Clapham Common
  - Clapham Common to Clapham South
  - Clapham South to Balham
  - Balham to Tooting Bec
  - Tooting Bec to Tooting Broadway
  - Tooting Broadway to Colliers Wood
  - Colliers Wood to South Wimbledon
  - South Wimbledon to Morden
  - Morden Depot Boundary Roads
- Platform Grounds (All)
    - High Barnet
    - Totteridge & Whetstone
    - Woodside Park
    - Finchley Central
    - East Finchley
    - Highgate
    - Archway
    - Tufnell Park
    - Kentish Town
    - Camden Town
    - Chalk Farm
    - Golders Green
    - Euston
    - Kings Cross
    - Angel
    - Mornington Crescent
    - Leicester Square
    - Charing Cross
    - Oval
    - Clapham North
    - Balham
    - Tooting Broadway
- Piccadilly Line:
    - Track Sections – Both Directions
      - Cockfosters to Oakwood
      - Oakwood to Southgate
      - Southgate to Arnos Grove
      - Arnos Grove to Bounds Green
      - Bounds Green to Wood Green
      - Wood Green Sidings
      - Wood Green to Turnpike Lane

- Turnpike Lane to Manor House
  - Manor House to Finsbury Park
  - Finsbury Park to Arsenal
  - Arsenal to Holloway Road
  - Holloway Road to Caledonian Road
  - Caledonian Road to Kings Cross
  - Kings Cross Loop
  - Kings Cross to Russell Square
  - Russell Square to Holborn
  - Holborn to Covent Garden
  - Covent Garden to Leicester Square
  - Piccadilly Circus to Green Park
  - Green Park to Hyde Park Corner
  - Hyde Park Corner to Knightsbridge
  - Down Street Sidings
  - Knightsbridge to South Kensington
  - South Kensington to Gloucester Road
  - Earls Court to Barons Court
  - Acton Town to South Ealing
  - Northfields to Boston Manor
  - Osterley to Hounslow East
  - Hounslow West to Hatton Cross
  - Heathrow Loop
  - Raynors Lane to South Harrow
  - South Harrow to Sudbury Hill
  - Sudbury Hill to Sudbury Town
  - Alperton to Park Royal
  - Park Royal to North Ealing
  - North Ealing to Ealing Common
  - Baker Street to Bond Street
  - Bond Street to Green Park
  - Green Park to Charing Cross
- Platform Grounds (All)
    - Cockfosters
    - Finsbury Park
    - Arsenal
    - Holloway Road
    - Caledonian Road
    - Russell Square
    - Hyde Park Corner
    - Knightsbridge
- can be classed as **HIGH** priority due to either the number and type of ACM's they contain and therefore can be restricted to **re-inspections every 12 months**:
    - Jubilee Line:
      - Track Sections – Both Directions
        - Finchley Road to Swiss Cottage
        - Swiss Cottage to St Johns Wood
        - St Johns Wood to Baker Street
      - Platform Grounds (All)
        - None
    - Northern Line:
      - Track Sections – Both Directions



- Finchley Central to East Finchley
  - East Finchley to Highgate
  - Highgate to Archway
  - Archway Sidings
  - Hampstead to Golders Green
  - Camden Town to Euston
  - Waterloo to Kennington
- Platform Grounds (All)
    - None
- Piccadilly Line:
    - None